

ISO A1 594mm x 841mm

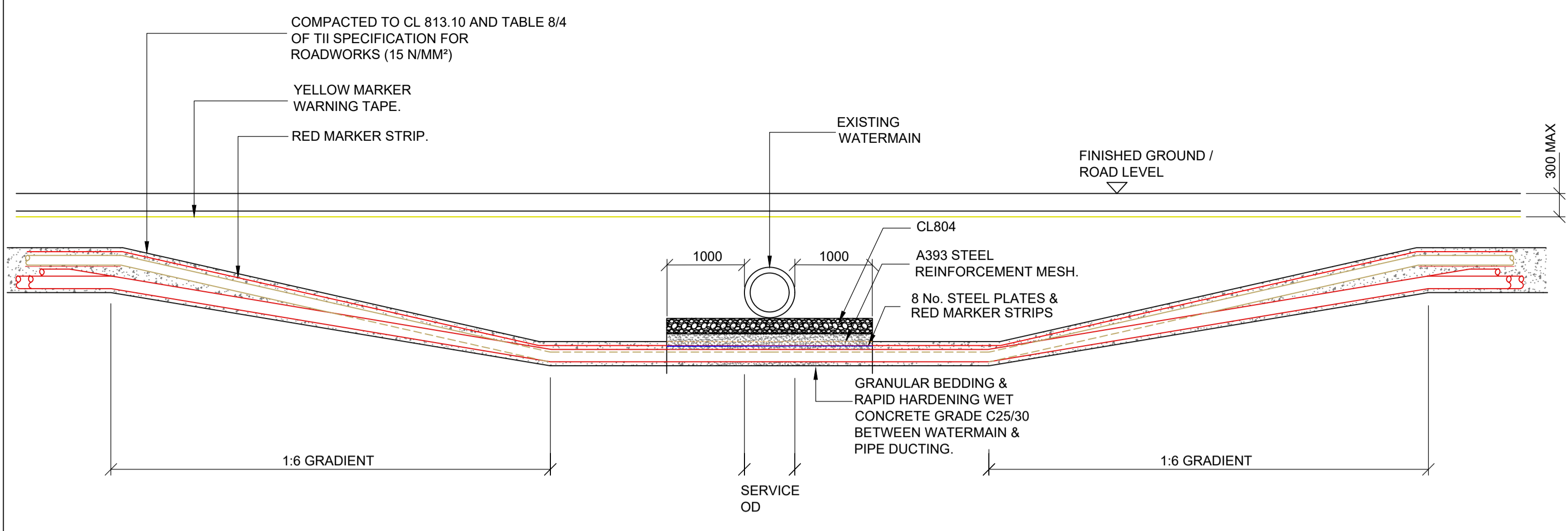

**SECTION A-A**  
SCALE 1:50

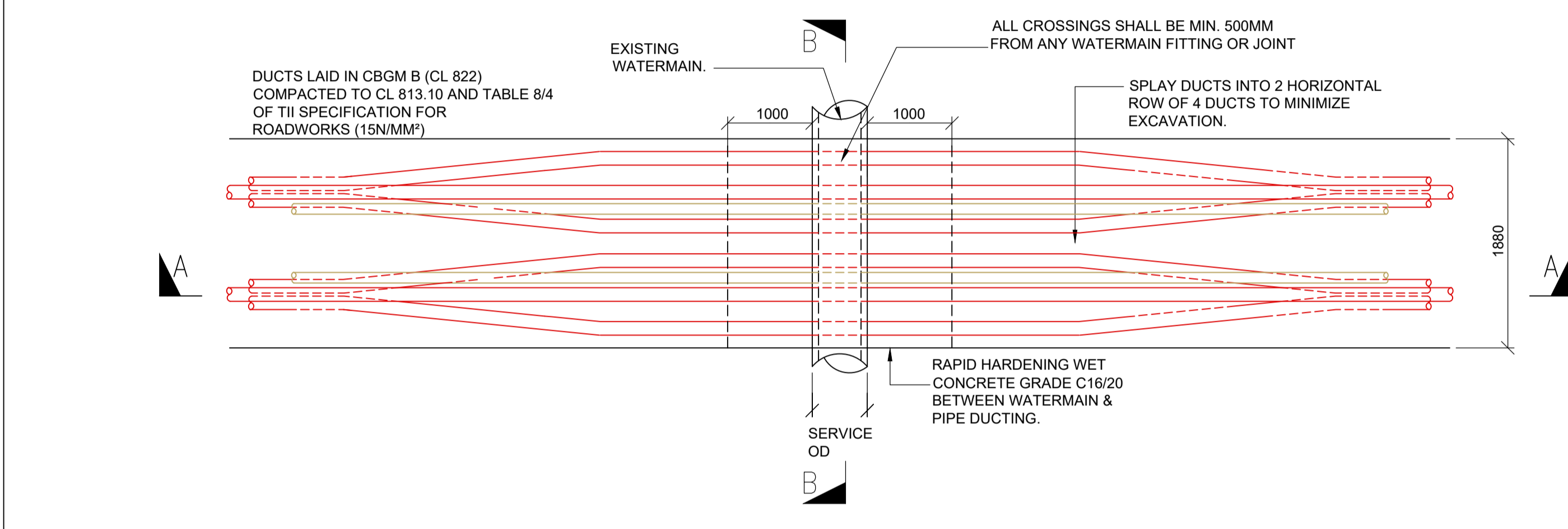

**PLAN VIEW**  
SCALE 1:50

**38kV DOUBLE CIRCUIT DETAILS - 2. WATERMAIN UNDERCROSSING**

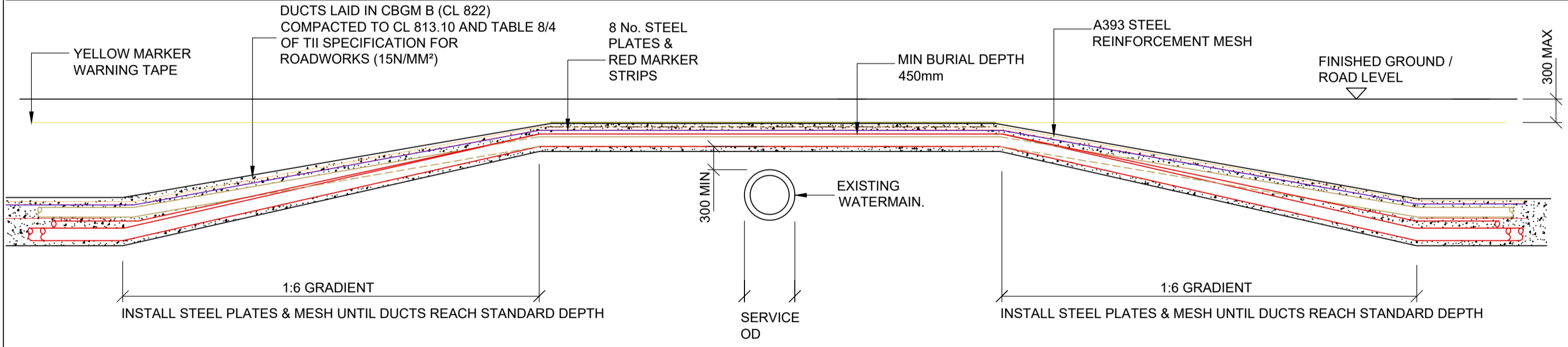

**SECTION C-C**  
SCALE 1:50

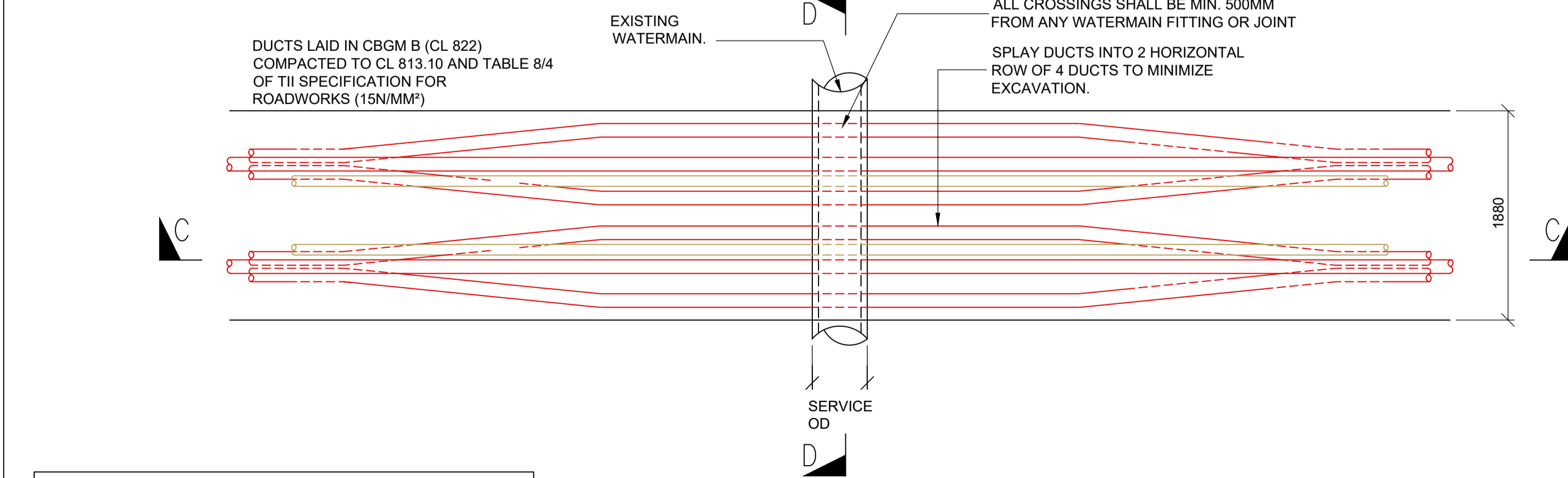

**PLAN VIEW**  
SCALE 1:50

**38kV DOUBLE CIRCUIT DETAILS - 2. WATERMAIN OVERCROSSING**

**LEGEND**

	110mm Ø HDPE POWER DUCT WITH 12mm DIAMETER PULL ROPE
	110mm Ø HDPE COMMUNICATION DUCT WITH 12mm DIAMETER PULL ROPE
	RED MARKER STRIP OR STEEL PLATES
	YELLOW MARKER WARNING TAPE
	A393 STEEL REINFORCEMENT MESH
	6mm GALVANISED STEEL PLATE

**NOTES**

- This drawing is to be read in conjunction with all other relevant documentation.
- Do not scale from this drawing use only printed dimensions.
- All dimensions are in millimetres, all chainages, levels and co-ordinates are in metres unless defined otherwise.
- This drawing is to be read in conjunction with the project Health & Safety file for any identified potential risks.
- No excavation shall commence until the contractor has consulted up to date services drawings and carried out an Electromagnetic Locator (EML) Scan.
- Hand dig only within 500mm of existing services.
- If compacting CBGM B could cause damage to the culvert / service below, use rapid hardening cement grade C25/30 following engineers prior approval.
- For standard trench cross section drawings and minimum horizontal separation to existing services, see 05649-213-214 (TREFOIL) and 05649-220 (FLAT).
- Where depths exceed 3000mm to the top of duct the contractor shall consult the cable system design engineer for phase spacing requirements.
- All works shall be in accordance with Irish Water code of practice for infrastructure.
- Backfill as per guidelines for the opening, backfilling and reinstatement of openings in public roads (2015)
- As per WIS 4-08-02 & IGN 4-08-01 granular material shall be 14mm to 5mm graded aggregate or 10mm single sized aggregate

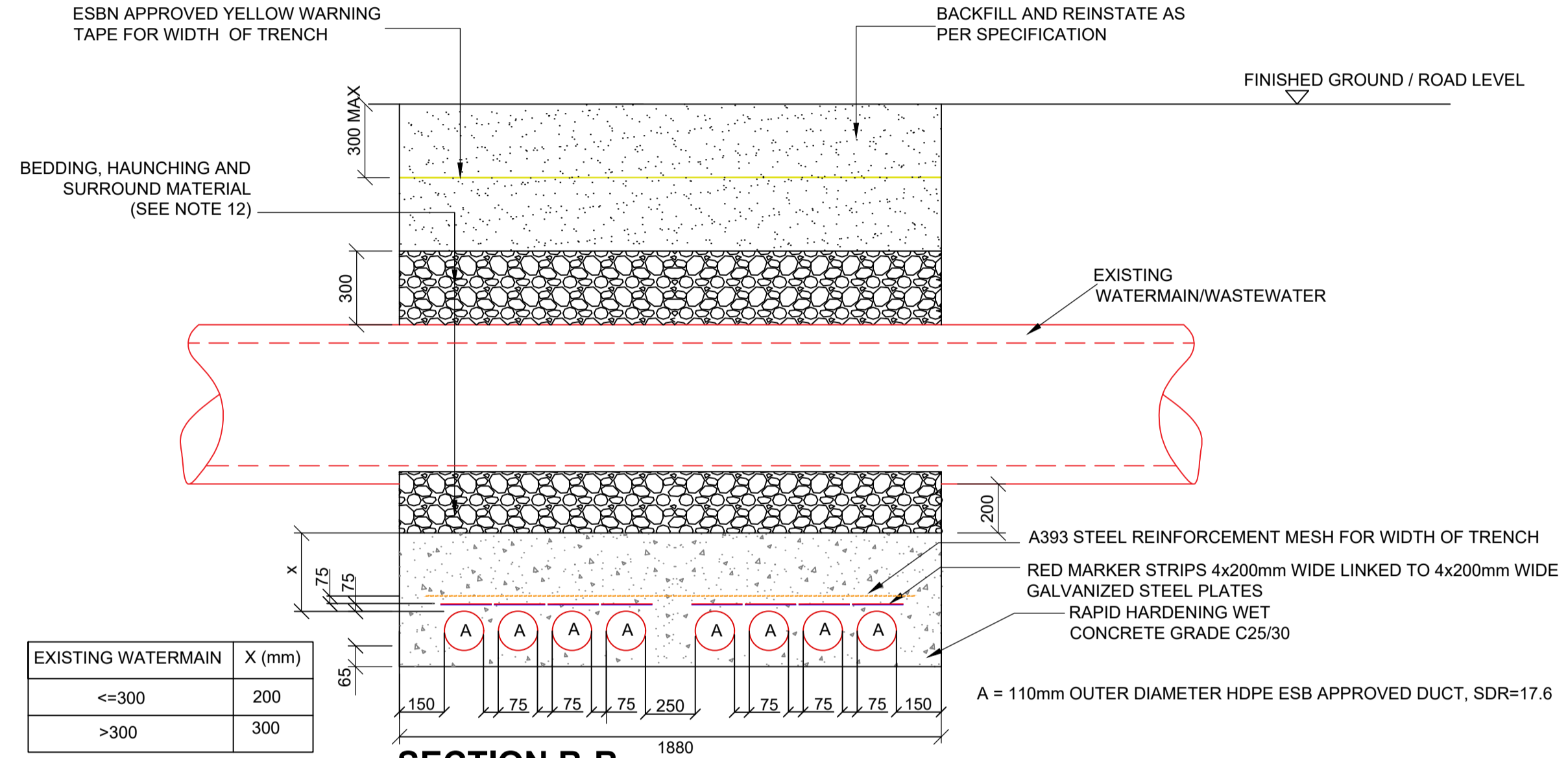

**SECTION B-B**  
SCALE: NTS

EXISTING WATERMAIN	X (mm)
<=300	200
>300	300

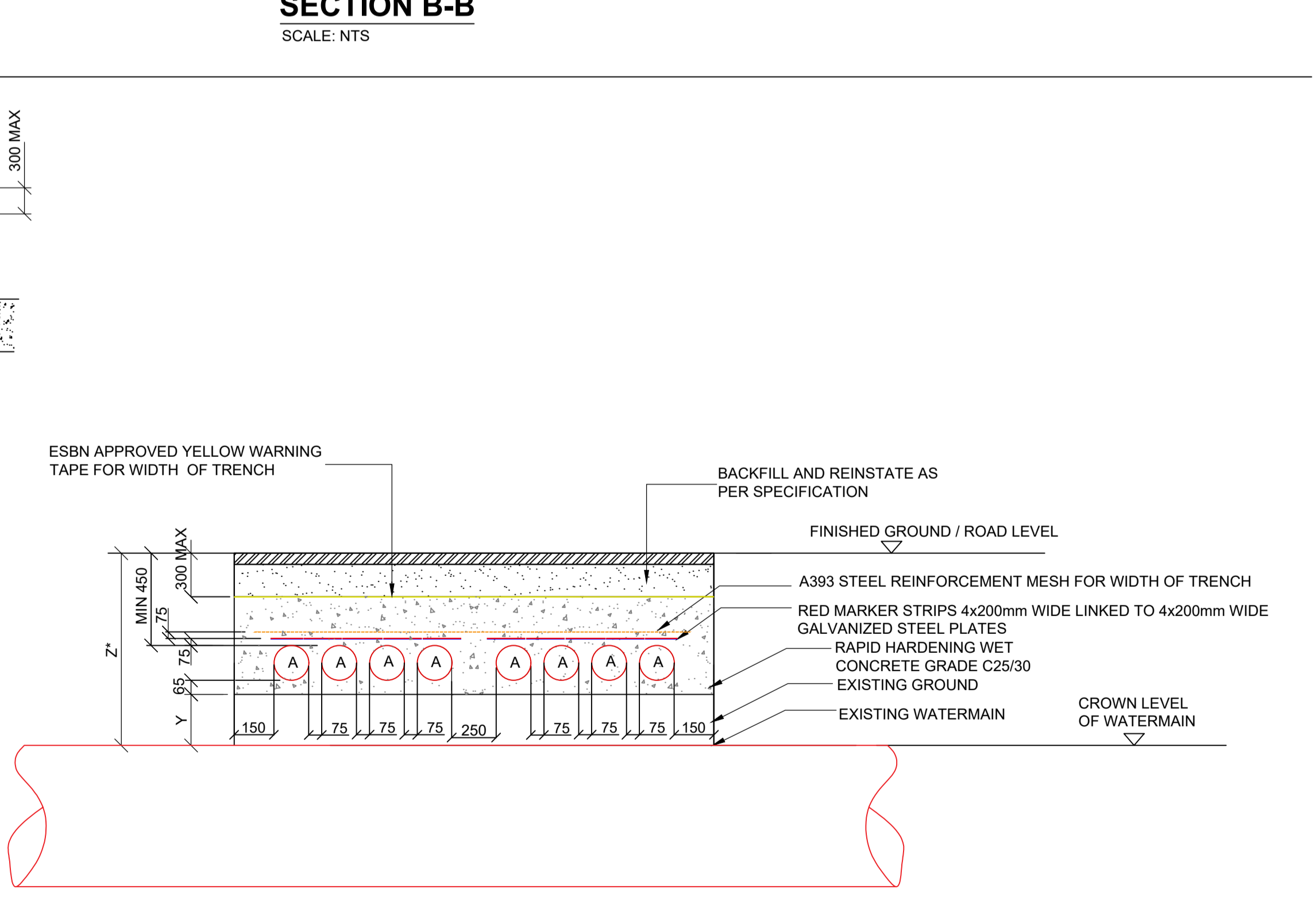

**SECTION D-D**  
SCALE: NTS

EXISTING WATERMAIN	Y (mm)	Z* (mm)
<=300	235	885 MIN
>300	435	1085 MIN

\* ALL EXISTING SERVICES WITH COVER LESS THAN MIN. DIMENSIONS ABOVE SHALL BE CROSSED BY UNDERCROSSING METHOD

Head Office  
Beenleigh,  
Abbeydorney,  
Tralee, Co. Kerry  
Ireland  
Tel: 00353 66 7135710

Regional Office  
Basepoint Business Centre  
Stroudley Road, Basingstoke,  
Hampshire,  
RG24 8UP, UK  
Tel: 00 44 1256406664

PROJECT  
**Kilcock SHD**

CLIENT  
**McGarrell Reilly Group**

CONSULTANTS

NOTES: -  
• See notes in drawing window

LEGEND: -

ISSUE/REVISION		
NO.	DATE	DESCRIPTION
P01	18.12.19	Issued for Planning
I/R	DATE	DESCRIPTION

PROJECT NUMBER  
**05-731**

SHEET TITLE  
**38kV Double Circuit - Watermain / Wastewater Crossing Detail**

SHEET NUMBER  
**TLI-05731-GC-DR-P-226**